

HOW TO EMBROIDER **CONTINUOUS BORDER & EDGINGS** **INSTRUCTIONS**

Project and designs in this project are copyrighted to

www.myembroideryhaven.com





MATERIALS USED TO TEST THIS:

- Embroidery Thread: Floriani Poly 40 weight White: PF801
- Bobbin Thread: if you wish your project to look the same on both sides, use the same thread in the bobbin as on top, or use 60 weight poly bobbin thread.
- Water Soluble Stabilizer: 1 layer of Wet N Gone by Floriani
- Needle: Size 90/14
- Washable Spray Adhesive or Washable Glue Stick
- Self-Erasing or Washable marker
- Software to print templates (Embird is great to print templates but many others can do just as well. Wilcom offers TrueSizer9 for free on their website. Tajima Pulse offers the free Ambassador software, which can also help you print a template with their software. (See <http://www.myembroideryhaven.com/templates.html>)
- Appliqué scissors, if you have them, or embroidery scissors
- Fray Check, anti-fray product (optional) Required only if you are doing an edging where you will be cutting the fabric and if the fabric is the kind that frays a lot.

Continuous Border/Edging Instructions

1. The secret to perfect edgings is to be well prepared. If you try to cut corners, that's when it starts to go wrong. The more you prepare, the better results you get. The first thing to do is to print out your templates and cut them out. If you have never done that and are unsure of how to proceed, go to this page on my website and follow the directions: See <http://www.myembroideryhaven.com/templates.html> or go to the home page of our website and on the left of the screen, click on HOW TO? In there you will find the link to "How to make a template". Print out the number of templates you actually need to have your entire project on paper. Of course, if you are doing an entire tablecloth, you would not want to print that much. I suggest starting with a little doily first to get the hang of measuring and marking your project.

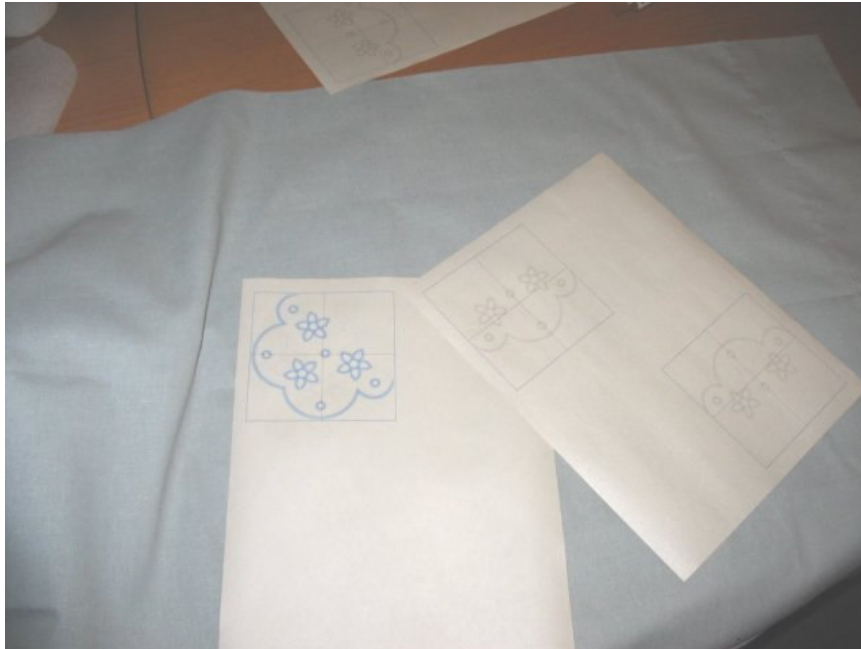

2. Place your template on your fabric to decide on the placement you prefer. Then with the help of a ruler and the washable or self erasing marker, trace lines that you will be able to follow when embroidering. Normally you would embroider one design after the other going around your item.

Note on the second picture how I cut around my border template to really expose the tip of it. This is so that I could actually SEE how I would overlap over the previous embroidered design. You can also see how I used the crosshair mark of the template to align with my markings on the fabric.

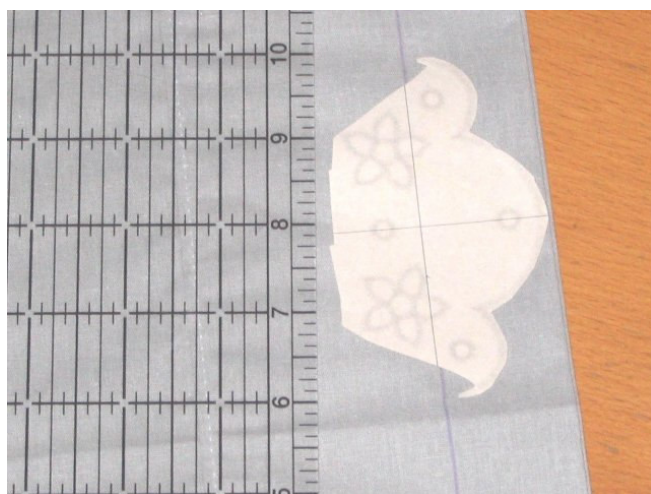
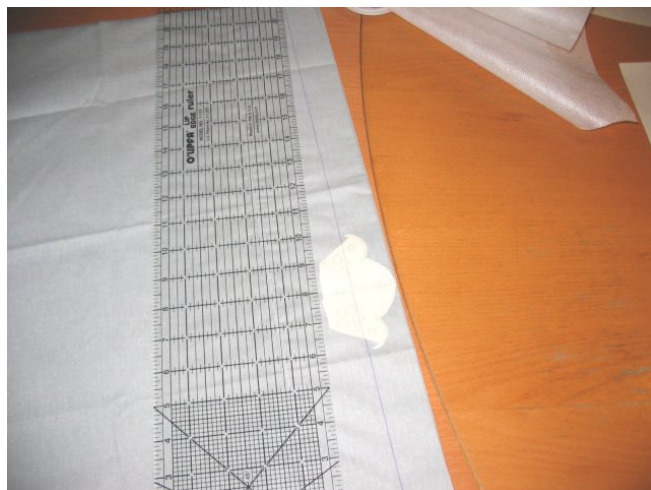

3. In order to embroider a continuous border, it is a lot simpler NOT to hoop the fabric. What you need to do is hoop one layer of Wet N Gone. (If you are using other kinds of water-soluble stabilizer, you might need more than one layer). Then either use spray adhesive or use your washable glue stick and apply it to the water-soluble stabilizer. Note that I always place my hoop in a cardboard box when I want to use the spray. This prevents everything around it from getting sticky. Also, you should know that the Floriani products include the Wet N Gone Fusible. For those of you who would rather not use sprays of any kind, with the help of a mini-iron, you could simply fuse the part that you will be embroidering to the Wet N Gone Fusible right in the hoop. I didn't use it here because I was using a self-erasing marker and you can't iron the marks from that marker.



4. Place your fabric on your water-soluble stabilizer. Use the markings on the hoop to find your center and align the fabric properly. Tip: Lay your cutting mat under the hoop and align the center marks on your hoop on one of the lines of the mat to make it easier for you to place your fabric on a straight line.

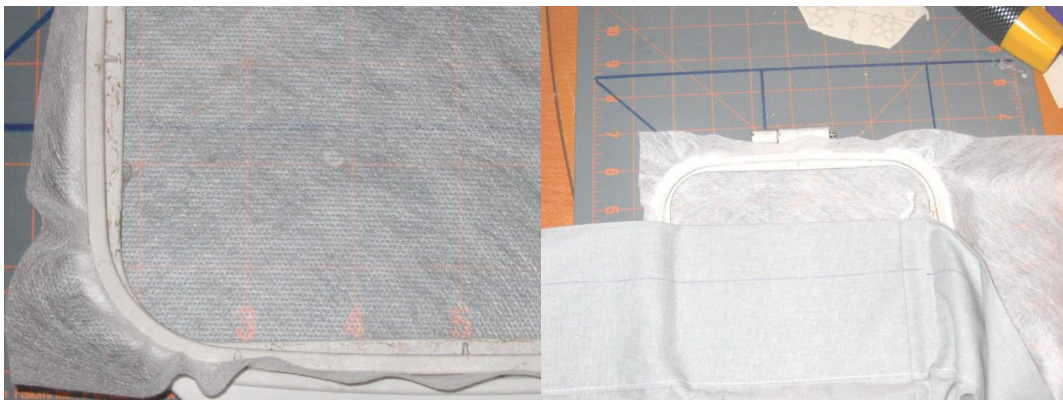

5. Place the hoop on your machine and align your template. Once the template is in place, use the buttons on your machine and move the needle so that it will be perfectly aligned with the center of the template as shown. Then run the first stitch color.

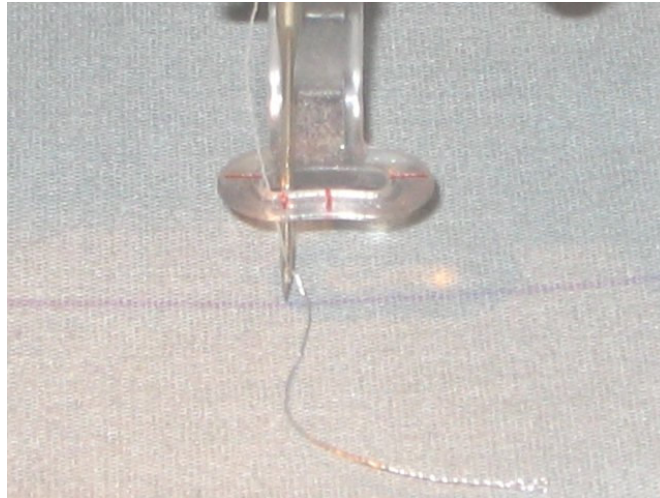

6. Once the first design is embroidered, remove the work from the hoop and remove the excess stabilizer. Hoop another piece of water-soluble stabilizer. Spray the adhesive and place the fabric like we did before, taking care to align with the markings. Place the hoop on the machine again.

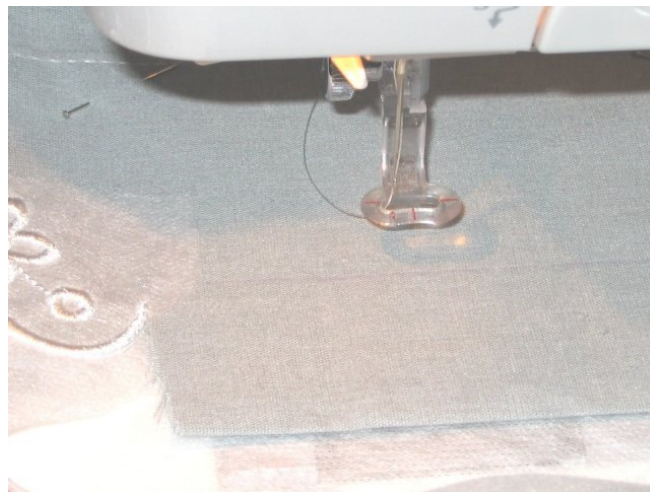

7. When doing a continuous border, you are stitching the same design again. Using your template, place it on the fabric and align the centerline on the template with your mark on the fabric. Now slide the template and overlap just enough over the end of the first design to have the beginning of the second design join perfectly, once you are done embroidering the second design. The stitches you see on the template are where the stitches will lie when you are finished embroidering the design. The first picture shows you the overlap with the previous embroidered design. The second picture shows you how the crosshair on my template is aligned with my markings on my fabric to make sure that I am perfectly aligned. In the third picture I used the buttons on my machine to align myself straight in the center of my template, making sure that the design on my machine is centered, this is how I know for sure where my design will stitch.

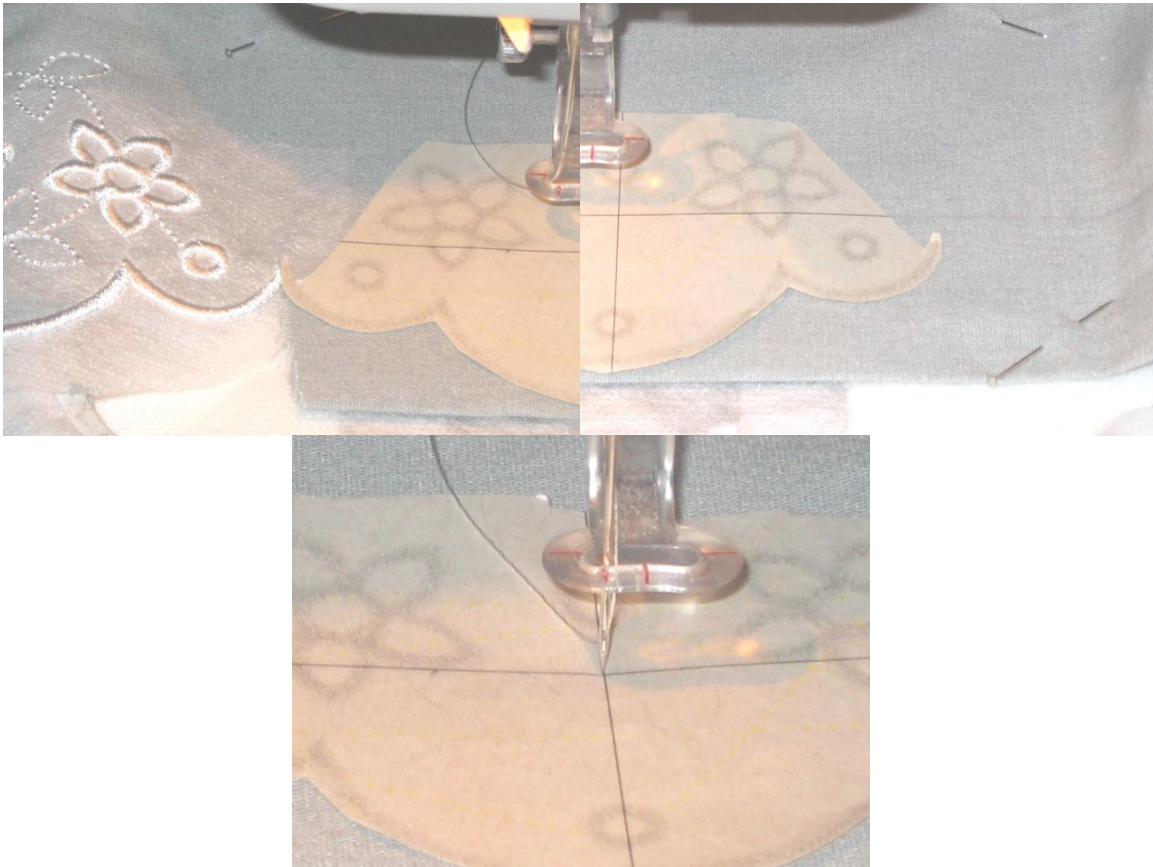

8. Special note for edgings. When doing edgings, you will want to cut out the excess fabric before stitching the satin stitches. Be careful to not cut too much fabric at the end of your design where you will be stitching the second design because you will have troubles if there is no fabric for the second design. Cut wide as I did when starting to cut, but stop cutting just a stitch or two before the end of the running stitches. This is so that the satin stitches of the first design will cover that tiny bit of fabric left but you will have not have removed any of the fabric necessary for the next design.



9. Keep going around the project until completed and Voila!



We wish you happiness and success in your projects. If you have any questions, please don't hesitate to email us. Thank You

Marie-Josée Mailloux

Website: www.myembroideryhaven.com

Group: <http://groups.yahoo.com/group/MyEmbroideryHaven>

Email: marie@myembroideryhaven.com

© My Embroidery Haven 2005